

# MATRIX BUSINESS CENTRE



 **EAGLE  
BUILDERS**  
THE PRECAST CONCRETE CONNECTION

## STRATA OFFICE / WAREHOUSE FOR SALE

2030 MATRIX CRESCENT, KELOWNA BC  
11 UNITS AVAILABLE FROM 3,299 SF – 43,161 SF

**STEVE LAURSEN**  
PERSONAL REAL ESTATE CORPORATION  
INDUSTRIAL. COMMERCIAL. INVESTMENT REAL ESTATE



**MATRIX CRESCENT**

**PROPERTY DETAILS**

**MUNICIPAL ADDRESS**  
2030 Matrix Court, Kelowna BC

**BUILDING SIZE**  
Ground Floor: 29,451 SF  
Mezzanine: 13,710 SF  
Total SF: 43,161 SF

**ZONING**  
CD15

**POSSESSION**  
Summer 2021

**THE OPPORTUNITY**

Matrix Business Centre will offer purchasers an opportunity to own in the Airport Business Park. Purchasers will be able to accommodate their warehouse and office needs within a brand new Precast concrete development that offers Purchasers flexibility to combined spaces from 3,299 to 43,161 square feet with ample parking on site.

**MATRIX BUSINESS CENTRE**

# MATRIX BUSINESS CENTRE



## FEATURES

- 24' clear height
- 200 Amp 3 phase 120/208V power
- At-grade loading bays with 12' (H) x 12' OH doors
- Built-in open mezzanine with 100 lb psf load capacity
- HVAC stubbed in to mezzanine
- 300 lb psf load capacity on the main floor
- Rough in plumbing for future washrooms provided
- Minimum 3 parking stalls per unit.
- Possession Summer 2021

# FLOOR PLAN

UNIT	GROUND FLOOR	MEZZANINE	TOTAL SF	PRICE
101	2,285 SF	1,600 SF	3,885 SF	<b>SOLD</b>
102	4,426 SF	1,747 SF	6,173 SF	\$1,728,440
103	2,325 SF	974 SF	3,299 SF	\$989,700
104	2,325 SF	974 SF	3,299 SF	<b>SOLD</b>
105	2,325 SF	974 SF	3,299 SF	\$989,700
106	2,325 SF	974 SF	3,299 SF	\$989,700
107	2,325 SF	974 SF	3,299 SF	<b>SOLD</b>
108	2,325 SF	974 SF	3,299 SF	<b>SOLD</b>
109	2,325 SF	974 SF	3,299 SF	<b>SOLD</b>
110	4,425 SF	1,747 SF	6,172 SF	\$1,728,160
111	3,000 SF	1,758 SF	4,758 SF	PENDING

\*Units 102 & 110 have 1 - 12' x 14' OH door

Updated June 3, 2021

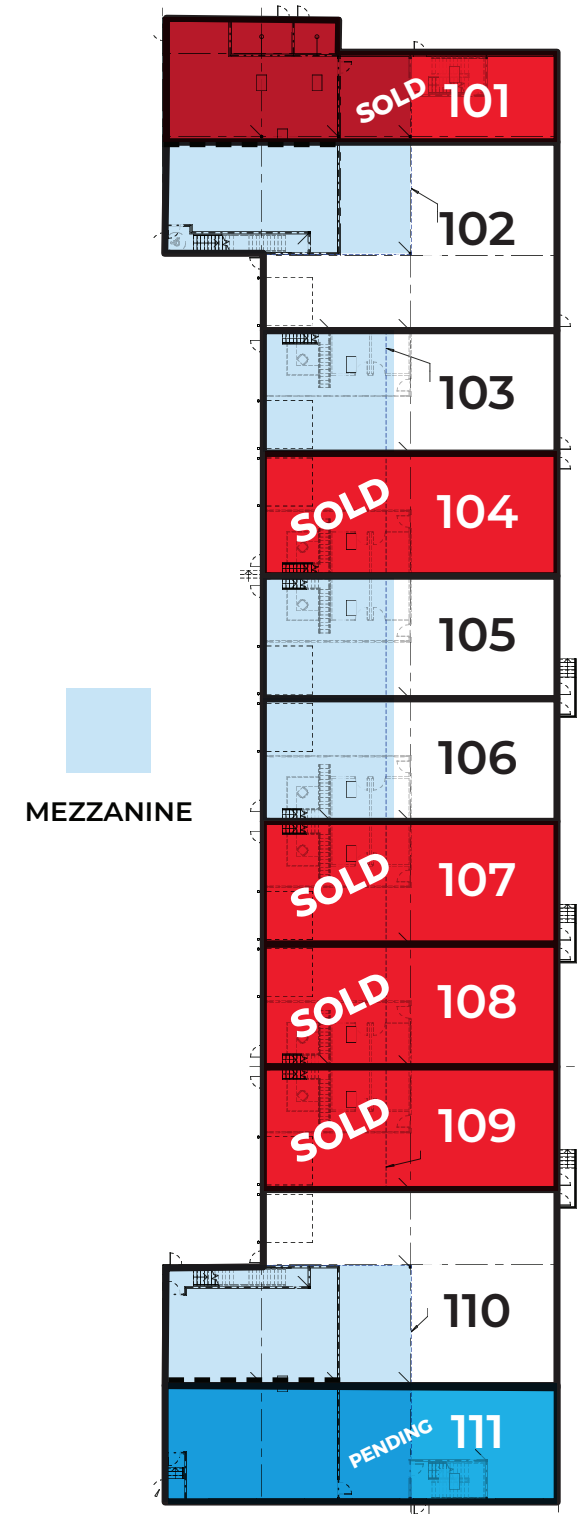

# MATRIX BUSINESS CENTRE

## LOCATION OVERVIEW

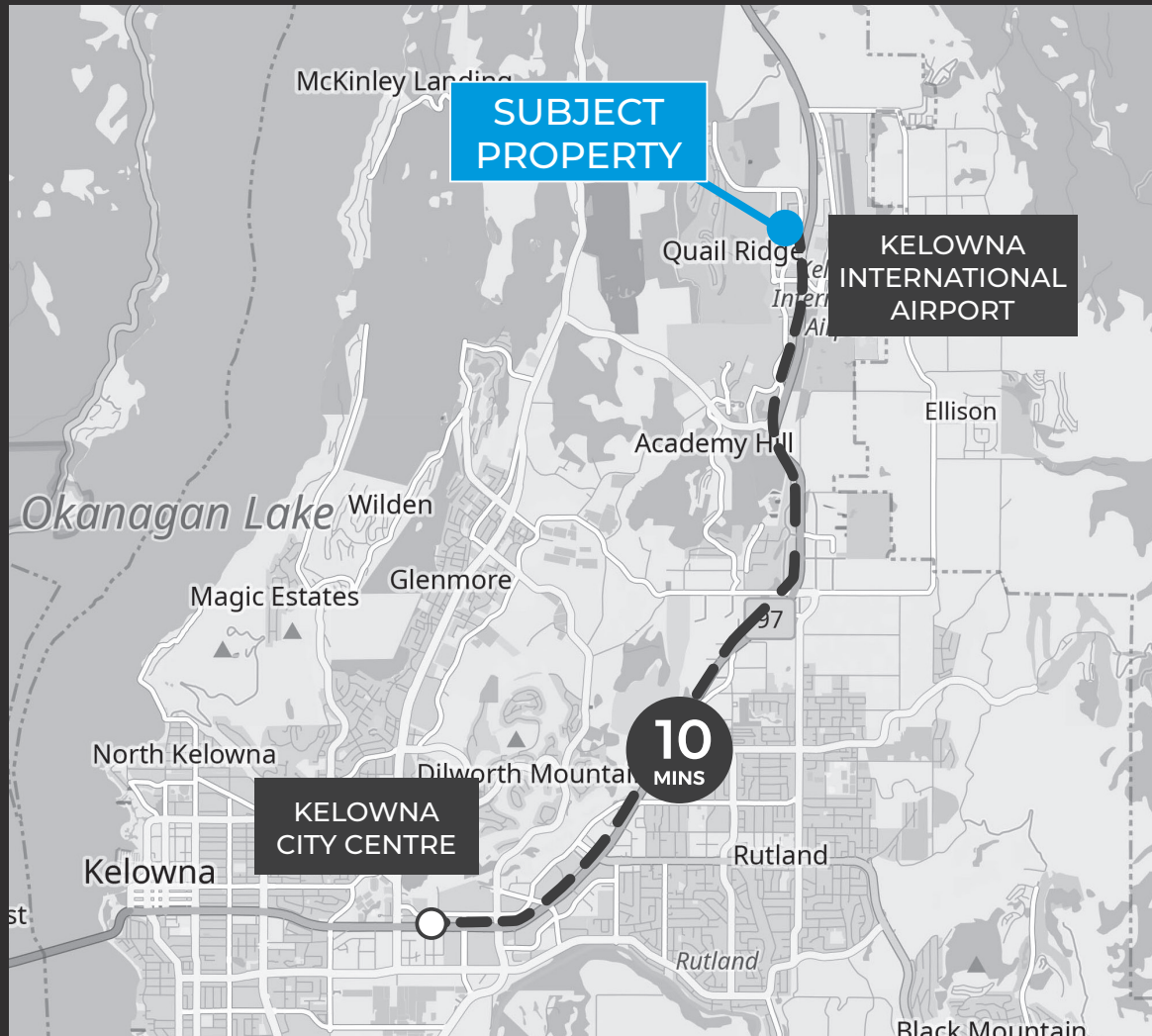

# CONTACT

## STEVE LAURSEN

PERSONAL REAL ESTATE CORPORATION

250.808.8101

stevelaursen@royallepage.ca

www.stevelaursen.com



# MATRIX BUSINESS CENTRE

This disclaimer shall apply to Steve Laursen Personal Real Estate Corporation (PREC\*), Royal LePage Kelowna Real Estate Brokerage, and to all other divisions of the Corporation; to include all employees and independent contractors.

The information set out herein, including, without limitation, any projections, images, opinions, assumptions and estimates obtained from third parties (the "Information") has not been verified by Steve Laursen PREC\*, and Royal LePage Kelowna does not represent, warrant or guarantee the accuracy, correctness and completeness of the Information.

Steve Laursen PREC\* does not accept or assume any responsibility or liability, direct or consequential, for the Information or the recipient's reliance upon the Information.

The recipient of the Information should take such steps as the recipient may deem necessary to verify the Information prior to placing any reliance upon the Information. The Information may change and any property described in the Information may be withdrawn from the market at any time without notice or obligation to the recipient from Steve Laursen PREC\*.

Steve Laursen PREC\* and the Royal LePage Kelowna logo are the service marks of Steve Laursen PREC\* and Royal LePage Kelowna.

Limited and/or its affiliated or related companies in other countries. All other marks displayed on this document are the property of their respective owners.

All Rights Reserved.