

MATRIX BUSINESS CENTRE



THE PRECAST CONCRETE CONNECTION

STRATA OFFICE / WAREHOUSE FOR SALE

2030 MATRIX CRESCENT, KELOWNA BC
11 UNITS AVAILABLE FROM 3,299 SF – 43,161 SF

STEVE LAURSEN
PERSONAL REAL ESTATE CORPORATION
INDUSTRIAL. COMMERCIAL. INVESTMENT REAL ESTATE



MATRIX CRESCENT

PROPERTY DETAILS



MUNICIPAL ADDRESS
2030 Matrix Court, Kelowna BC



BUILDING SIZE
Ground Floor: 29,451 SF
Mezzanine: 13,710 SF
Total SF: 43,161 SF



ZONING
CD15



POSSESSION
Summer 2021

THE OPPORTUNITY

Matrix Business Centre will offer purchasers an opportunity to own in the Airport Business Park. Purchasers will be able to accommodate their warehouse and office needs within a brand new Precast concrete development that offers Purchasers flexibility to combined spaces from 3,299 to 43,161 square feet with ample parking on site.

**MATRIX
BUSINESS
CENTRE**

MATRIX BUSINESS CENTRE



FEATURES

- 24' clear height
- 200 Amp 3 phase 120/208V power
- At-grade loading bays with 12' (H) x 12' OH doors
- Built-in open mezzanine with 100 lb psf load capacity
- HVAC stubbed in to mezzanine
- 300 lb psf load capacity on the main floor
- Rough in plumbing for future washrooms provided
- Minimum 3 parking stalls per unit.
- Possession Summer 2021

FLOOR PLAN

UNIT	GROUND FLOOR	MEZZANINE	TOTAL SF	PRICE
101	2,285 SF	1,600 SF	3,885 SF	SOLD
102	4,426 SF	1,747 SF	6,173 SF	\$1,728,440
103	2,325 SF	974 SF	3,299 SF	\$989,700
104	2,325 SF	974 SF	3,299 SF	SOLD
105	2,325 SF	974 SF	3,299 SF	\$989,700
106	2,325 SF	974 SF	3,299 SF	\$989,700
107	2,325 SF	974 SF	3,299 SF	SOLD
108	2,325 SF	974 SF	3,299 SF	SOLD
109	2,325 SF	974 SF	3,299 SF	SOLD
110	4,425 SF	1,747 SF	6,172 SF	\$1,728,160
111	3,000 SF	1,758 SF	4,758 SF	SOLD

*Units 102 & 110 have 1 - 12' x 14' OH door

Updated July 15, 2021

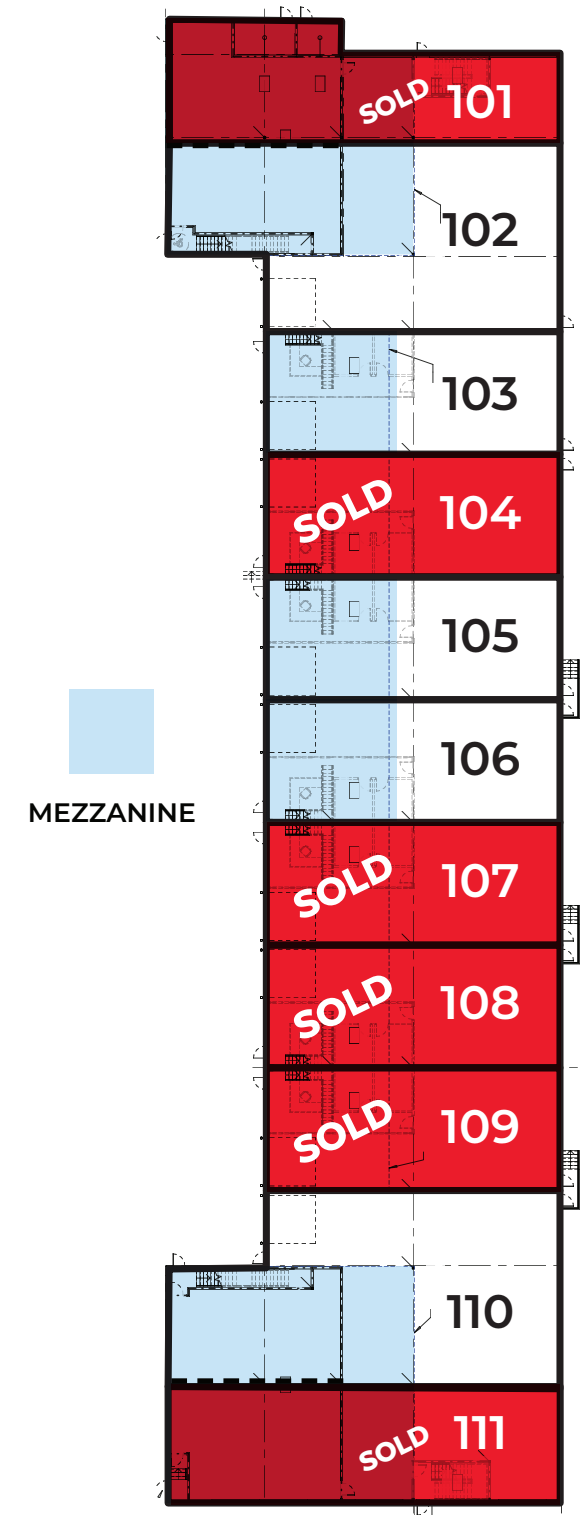

MATRIX BUSINESS CENTRE

LOCATION OVERVIEW



CONTACT

STEVE LAURSEN

PERSONAL REAL ESTATE CORPORATION

250.808.8101

stevelaursen@royallepage.ca

www.stevelaursen.com



ROYAL LEPAGE
COMMERCIAL



THE PRECAST CONCRETE CONNECTION

MATRIX BUSINESS CENTRE

This disclaimer shall apply to Steve Laursen Personal Real Estate Corporation (PREC*), Royal LePage Kelowna Real Estate Brokerage, and to all other divisions of the Corporation; to include all employees and independent contractors.

The information set out herein, including, without limitation, any projections, images, opinions, assumptions and estimates obtained from third parties (the "Information") has not been verified by Steve Laursen PREC*, and Royal LePage Kelowna does not represent, warrant or guarantee the accuracy, correctness and completeness of the Information.

Steve Laursen PREC* does not accept or assume any responsibility or liability, direct or consequential, for the Information or the recipient's reliance upon the Information.

The recipient of the Information should take such steps as the recipient may deem necessary to verify the Information prior to placing any reliance upon the Information. The Information may change and any property described in the Information may be withdrawn from the market at any time without notice or obligation to the recipient from Steve Laursen PREC*.

Steve Laursen PREC* and the Royal LePage Kelowna logo are the service marks of Steve Laursen PREC* and Royal LePage Kelowna.

Limited and/or its affiliated or related companies in other countries. All other marks displayed on this document are the property of their respective owners.

All Rights Reserved.